

# BRASS THREADED SWING CHECK VALVES

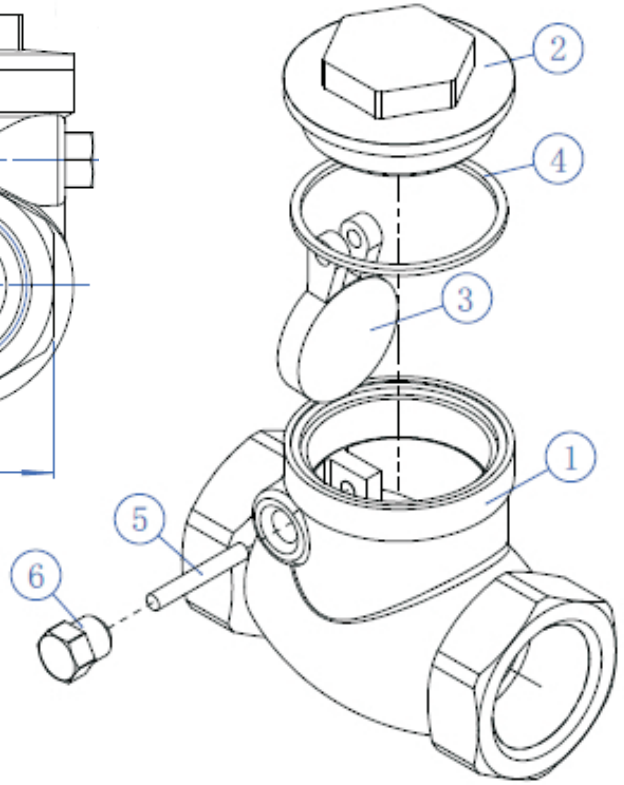
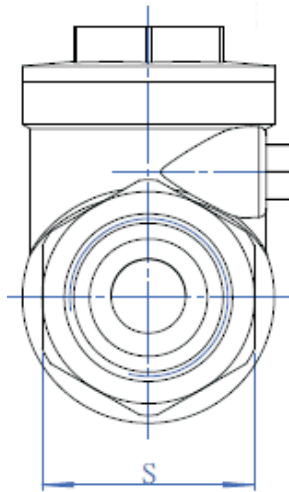
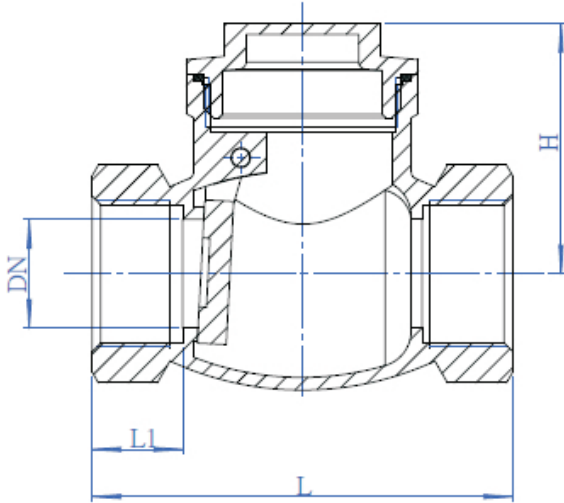

**Note:**  
This product is not suitable for a drinking water installation.

## Specifications

- Cast brass
- 200 CWP, 200 psi / 13.8 bar, non-shock
- Temperature range from -4 °F to 302 °F (-20 °C to 150 °C)
- Rated for: water, non-corrosive liquids & saturated steam
- Threaded ends: ANSI B1.20.1, solder ends: ANSI B16.18
- Brass to brass sealing
- Horizontal use only

## List of Materials

#	Part	Material
1	Body	Brass
2	Bonnet	Brass
3	Disc	Brass
4	Gasket	F4
5	Pin	Brass
6	Nut	Brass

BMI#	Size	L	H	DN	L1	S
14304	1/2"	2.2	1.3	0.5	0.5	1.0
14305	3/4"	2.3	1.5	0.1	0.5	1.2
14306	1"	2.6	1.7	0.8	0.6	1.5
14307	1 1/4"	3.1	2.0	1.0	0.6	1.9
14308	1 1/2"	3.2	2.3	1.2	0.7	2.1
14309	2"	3.6	2.5	1.4	0.7	2.5
14310	2 1/2"	4.6	3.2	1.9	0.8	3.2
14311	3"	5.9	3.5	2.3	1.0	3.9
14312	4"	7.0	4.2	3.3	1.1	4.9

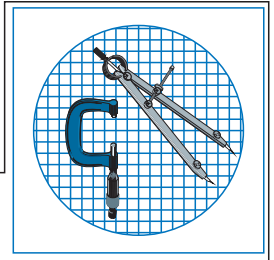

# BRASS SOLDER ENDS SWING CHECK VALVES

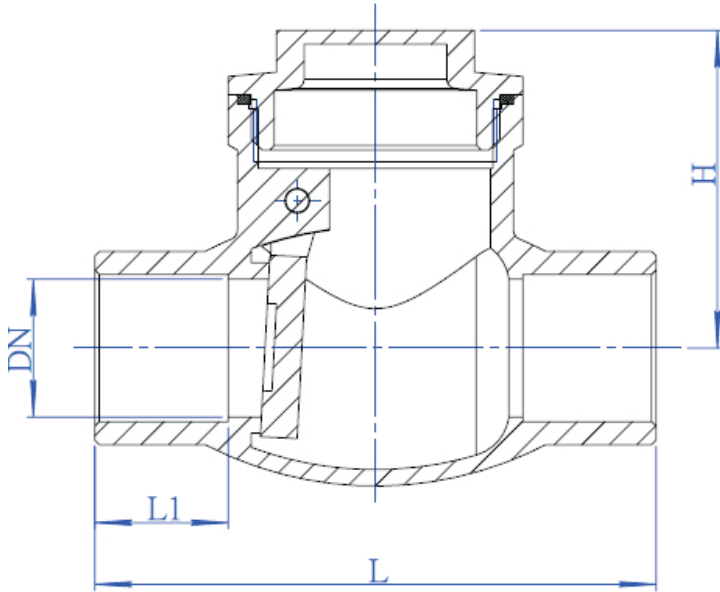

**Note:**  
This product is not suitable for a drinking water installation.

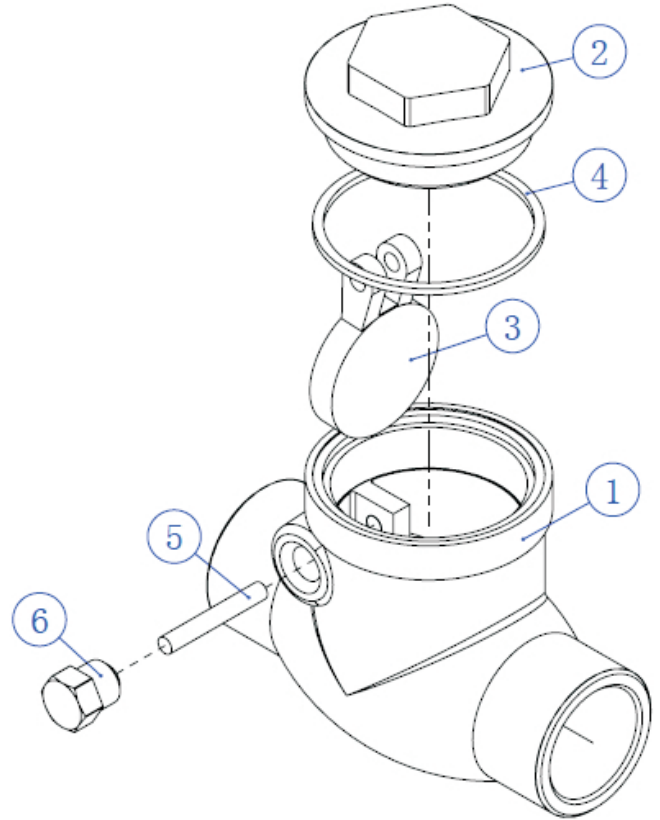

## Specifications

- Cast brass
- 200 CWP, 200 psi / 13.8 bar, non-shock
- Temperature range from -4 °F to 302 °F (-20 °C to 150 °C)
- Rated for: water, non-corrosive liquids & saturated steam
- Threaded ends: ANSI B1.20.1, solder ends: ANSI B16.18
- Brass to brass sealing
- Horizontal use only

## List of Materials

#	Part	Material
1	Body	Brass
2	Bonnet	Brass
3	Disc	Brass
4	Gasket	F4
5	Pin	Brass
6	Nut	Brass

BMI#	Size	L	H	DN	L1
14404	1/2"	2.7	1.4	0.4	0.8
14405	3/4"	3.0	1.6	0.6	1.0
14406	1"	3.5	1.7	0.8	1.1
14407	1 1/4"	4.3	2.0	1.0	1.2
14408	1 1/2"	4.8	2.2	1.2	1.3
14409	2"	5.4	2.6	1.4	1.3