



Cincinnati ~ Dallas

www.bmicanada.com



1-800-361-1452

1-800-561-8579

BMI USA FROST FREE FAUCETS PRICE LIST

**FFF
21-4**

September 10, 2021 (b)

NOT SUITABLE FOR POTABLE WATER

BMI ULTRA FROST FREE FAUCETS



COP or MIPS x 1/2"				
BMI#	Size	Packing	Barcode	\$
27404	4	1/25	777701274046	72.55
27406	6	1/25	777701274060	75.85
27408	8	1/25	777701274084	79.01
27410	10	1/25	777701274107	82.30
27412	12	1/25	777701274121	85.58
27414	14	1/25	777701274145	88.87
27418	18	1/25	777701274183	98.62

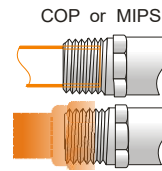

COP or MIPS x 3/4"				
27432	3/4" x 12"	1/25	777701274329	98.32

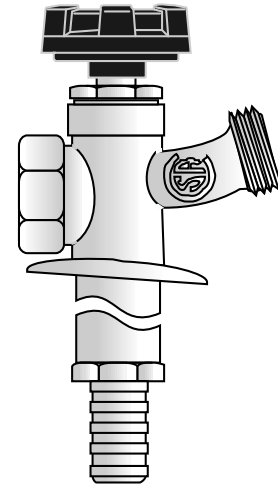

PEX x 1/2"				
27504	4	1/25	777701275043	83.41
27506	6	1/25	777701275067	87.21
27508	8	1/25	777701275081	90.88
27510	10	1/25	777701275104	94.61
27512	12	1/25	777701275128	98.41
27514	14	1/25	777701275142	102.21
27518	18	1/25	777701275180	113.41

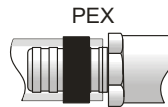

COLD EXPANSION x 1/2"				
27818	8	1/25	777701278181	106.01
27820	10	1/25	777701278204	110.48
27822	12	1/25	777701278228	114.87
27824	14	1/25	777701278242	119.26

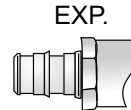

BRASS VACUUM BREAKER WITH LOCK SCREW

BMI#	Size	Packing	Barcode	\$
27001	3/4	1/72	777701270017	22.40



BMI HOT & COLD FROST FREE FAUCETS

BMI#	Size	Packing	Barcode	\$
27804	4	1/10	777701278044	245.83
27806	6	1/10	777701278068	271.95
27808	8	1/10	777701278082	294.98
27810	10	1/10	777701278105	319.58
27812	12	1/10	777701278129	338.02
27814	14	1/10	777701278143	368.73

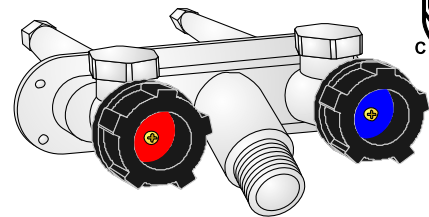
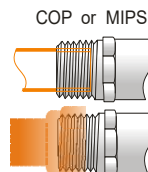

NOT SUITABLE FOR POTABLE WATER

PARTS FOR QUARTER TURN FAUCETS

STEM ASSEMBLY REPLACEMENT KITS

BMI#	Size	Packing	Barcode	\$
27604	4	1/25	777701276040	32.01
27606	6	1/25	777701276064	33.58
27608	8	1/25	777701276088	35.33
27610	10	1/25	777701276101	37.07
27612	12	1/25	777701276125	39.38
27614	14	1/25	777701276149	41.15
27618	18	1/25	777701276187	52.95



PARTS FOR ULTRA FAUCETS

STEM ASSEMBLY REPLACEMENT KIT

BMI#	Size	Packing	Barcode	\$
27704	4	1/25	777701277047	24.63
27706	6	1/25	777701277061	25.83
27708	8	1/25	777701277085	27.17
27710	10	1/25	777701277108	28.52
27712	12	1/25	777701277122	30.31
27714	14	1/25	777701277146	31.64
27718	18	1/25	777701277184	40.75

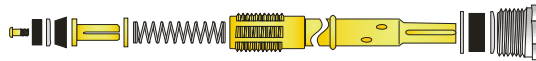

PARTS FOR INDONESIA FAUCETS

STEM ASSEMBLY REPLACEMENT KIT

BMI#	Size	Packing	Barcode	\$
27908	8	1/25	777701279089	23.42
27910	10	1/25	777701279102	24.59
27912	12	1/25	777701279126	26.12
27914	14	1/25	777701279140	27.31

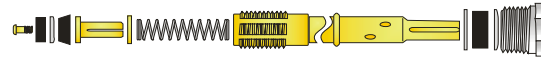

HOT & COLD STEM ASSEMBLY REPLACEMENT KITS

BMI#	Size	Packing	Barcode	\$
27924	4	1/25	777701279249	24.63
27926	6	1/25	777701279263	25.83
27928	8	1/25	777701279287	27.17
27930	10	1/25	777701279300	28.52
27932	12	1/25	777701279324	30.31
27934	14	1/25	777701279348	31.64

GENERAL REPLACEMENT PARTS

VACUUM BREAKER REPLACEMENT KIT

BMI#	Packing	Barcode	\$
27883	1/50	777701278839	7.33

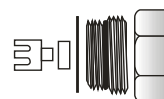

ALUMINUM with ABS COATING HANDLE REPLACEMENT KIT

BMI#	Packing	Barcode	\$
27884	25/100	777701278846	7.03

